

Commissioner of Highways

Gleason's Bridge- on the Champlain Canal

Application of Nelson Overrocker to alter Highway in Road District #3 between Gleason's Bridge & the road leading from Mechanicville to Waterford to either cross the Rensselaer & Saratoga Railroad

- **Nelson Overrocker Application: May 15th, 1869**
- **Application, Survey Map & Order: Filed Aug. 30th, 1869**
 - **Handrawn map showing the Railroad**
- **Lands taken from Childs & Stating :This is the Favorite Road"**
- **Document of John Gleason & Feldonias B. Badgers Aug. 30th, 1869 signed by Comm. of Highways & A.J. Gleason, Attorney**

To the Commissioners of Highways & Roads of West-
Moreland County, Md.

The undersigned a resident of said town and
able to be assessed for highway labor therein hereby
applies to the said Commissioners to allow the highway
in Road District No. 3. in said town from the
Garrison Canal bridge on the Chazy River
Canal to the road leading from Mammerville
to Watford in said town. said alteration
to made upon & through the lands now occupied
by Emil B. B. B. B. B. The proposed alteration
to be made is to change the route of said
road so as to enter Cross the Kentuckian
& Shenandoah Rail Road track above on
below its ^{is from} front. It is on account
of ~~the~~ "Bridg" which present it is a Judge
Bouvier and in a dangerous & unsafe
situation. Therefore your application contain
of the same as a nuisance and ask
said Commissioners to allow the route
of said road on these grounds
Said May 15 1884

Wm. C. Cracker

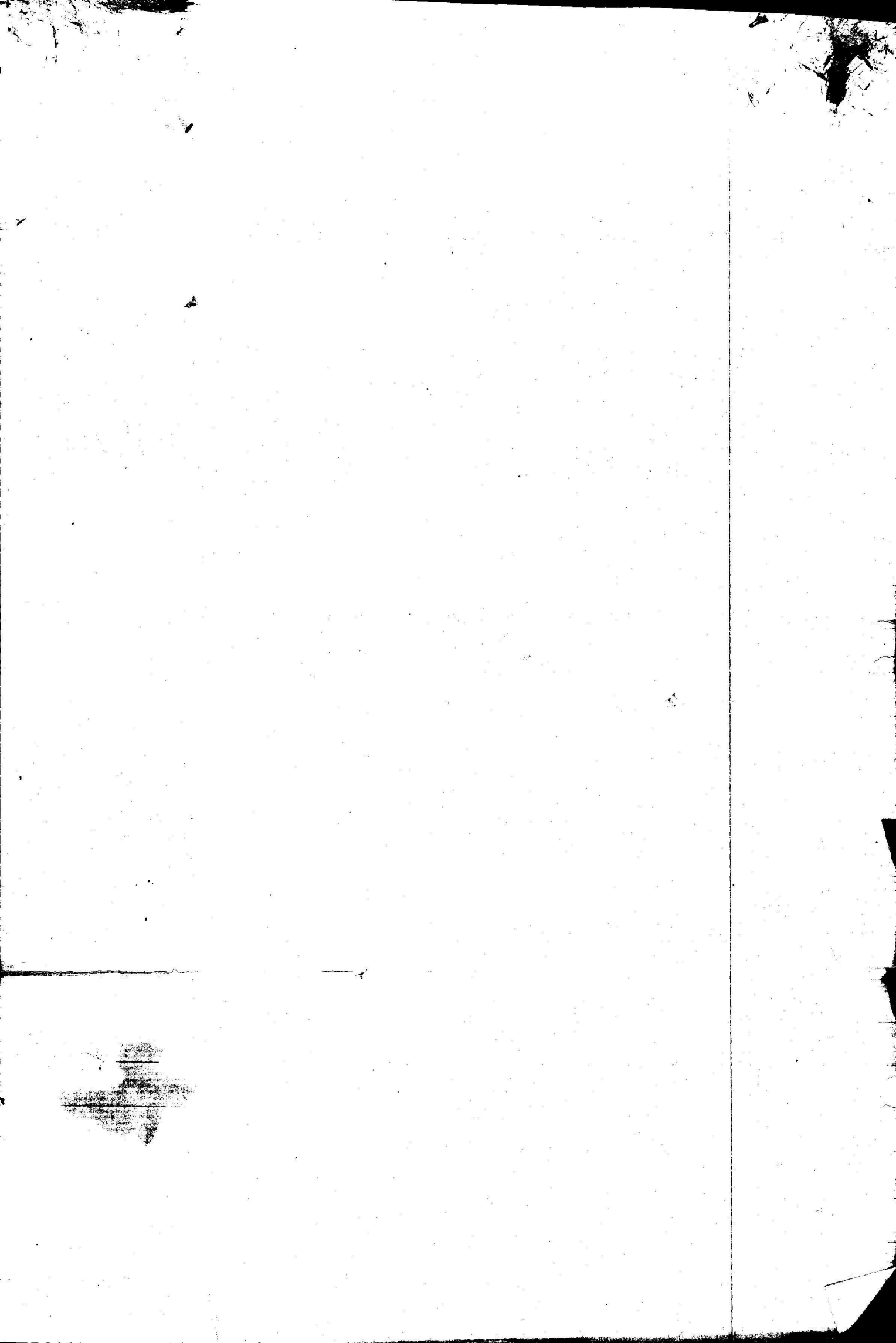

John C. Hallman Esq

In the matter of the

Objection of Highway in
Dist. No. 3.

Between

The Chautauque Council &
The Waterford Mechanical
Highway Town of Hall-
-town

Applicant's Survey -
Map and Order

Clifton R. Bradley

Comptroller of Public Lands

Filed in Office of Survey
Dist. No. 3, 1869. W. H.

~~James J. Reynolds~~ J. M.
James H. Clark

Survey Clerk

W. H. Blanton Attorney in Charge

Highway from Millville to Waterford

R.S. RR.

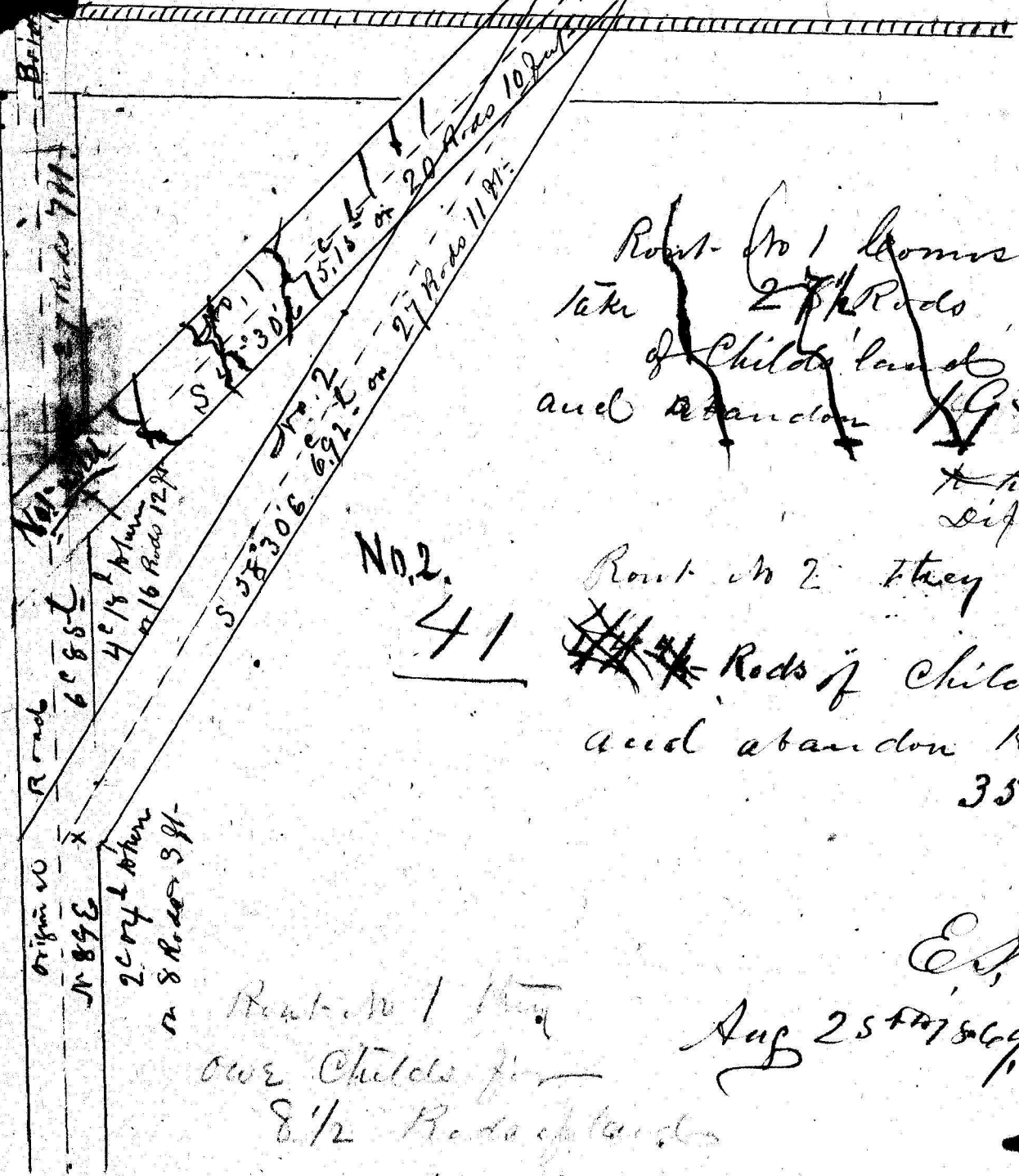

Route No 1 Commissioners
 take 27 Rods
 of Childs' land
 and abandon 19 Rods to him
 to him
 difference 8 1/2 Rods

No. 2.
41

Route No 2 they take
~~41~~ Rods of Childs' land
 and abandon to him
 35 1/2 Rods
 difference

Es. Movel
 Aug 25th 1869
 Survey 3

Route No 1 they
 owe Childs for
 8 1/2 Rods of land

No 2 for 6 Rods of land

No 2 is the favorite route



Route No 2

#1 Beginning at a point in the centre of the Original Highway Situated North Eighty-Nine degrees East Eight-rodz & three feet from State lands occupied by the Champlain Canal near the East End of Gleasons Bridge in the town of Adirondon Saratoga County - State of New York & running from thence South Fifty-Eight- degrees & thirty- minutes East Twenty seven Rods and Eleven feet through lands owned or occupied by Samuel Childz ~~and~~ across the Rensselaer and Saratoga Rail Road to the Highway leading from Mechanicville to Waterford

N.B. This is the Favorite Route

The Commissioners take — 41 Rodz of Childz lands & abandon — 35 — to him leaving due him for 6 Rodz of land — which is less than by the other Route only about $\frac{1}{27}$ of an acre difference in this case & about $\frac{1}{19}$ of an acre in the other Either of which is not worth much only the shape of his fields may be a little disfigured

Aug 25 1835

E. M. D.
Deputy

In the matter of the
Application of Nelson Overacker
to alter the Route of the Highway
in Road District No 3. Town
of Half Moon Saratoga County NY
Between Gleason's Bridge (on the
Champlain Canal) and the
Road leading from Mechanicville
to Waterford in said County

The undersigned Commissioners
of Highways in & for the Town of Half Moon Saratoga County NY
Having met upon the Grounds where said Road was complained of
as a nuisance and an application having been made to
to have the same altered by one Nelson Overacker a
resident of said Town & liable to be assessed for Highway
labor therein for the alteration of the route of road
between the Champlain Canal and the Highway
leading from Mechanicville to Waterford said alteration
to be made upon road known as Road District Number
3 in said Town All the said Commissioners having
been duly notified to attend this meeting of the Commis-
sioners for the purpose of deliberating on the subject of
this order do hereby order that the line of the said
road be and the same is hereby altered so as to run
from a point of Compass as surveyed by Edward J
Wood. whose Certificate and Map of the route is
hereto annexed which was taken according to the
points of his Compass August 24. 1869. Beginning
at a point in the Centre of the original Highway Situa-

